

CONTACT ORIENTATION
ON REEL FOR AUTO
CRIMP MACHINE

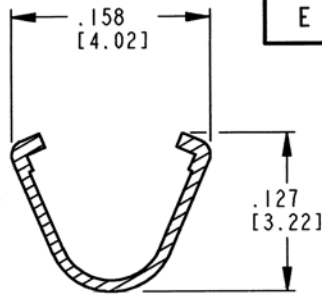

SECTION A-A
CONDUCTOR WINGS

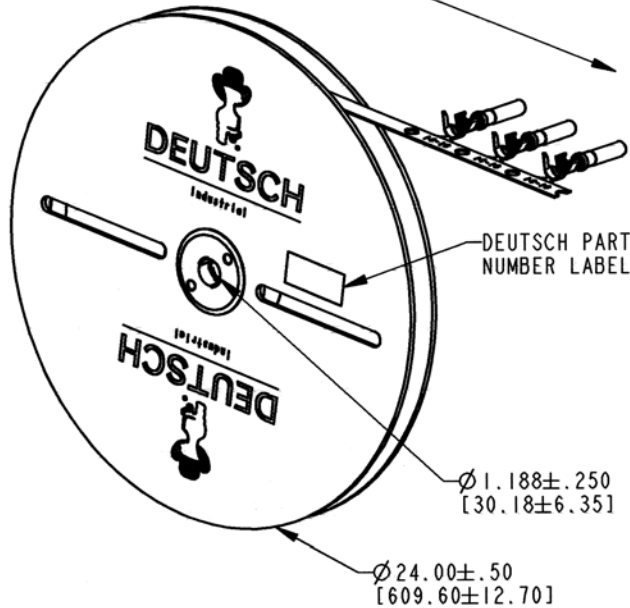
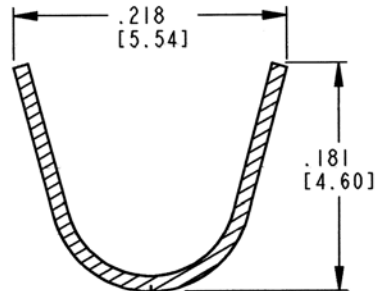

SECTION B-B
INSULATION WINGS

REV
E **1062-14-01****

REVISIONS			
SYM	DESCRIPTION	DATE	APPROVED
B	REDESIGNED/REDRAWN PER E.O. P16391	11-05-99	R.D.R.
C	REVISED PER E.O. P17000	12-08-00	R.D.R.
D	REVISED PER E.O. P19555	7-11-07	R.D.R.
E	REVISED PER E.O. P20396	6-25-10	ADR

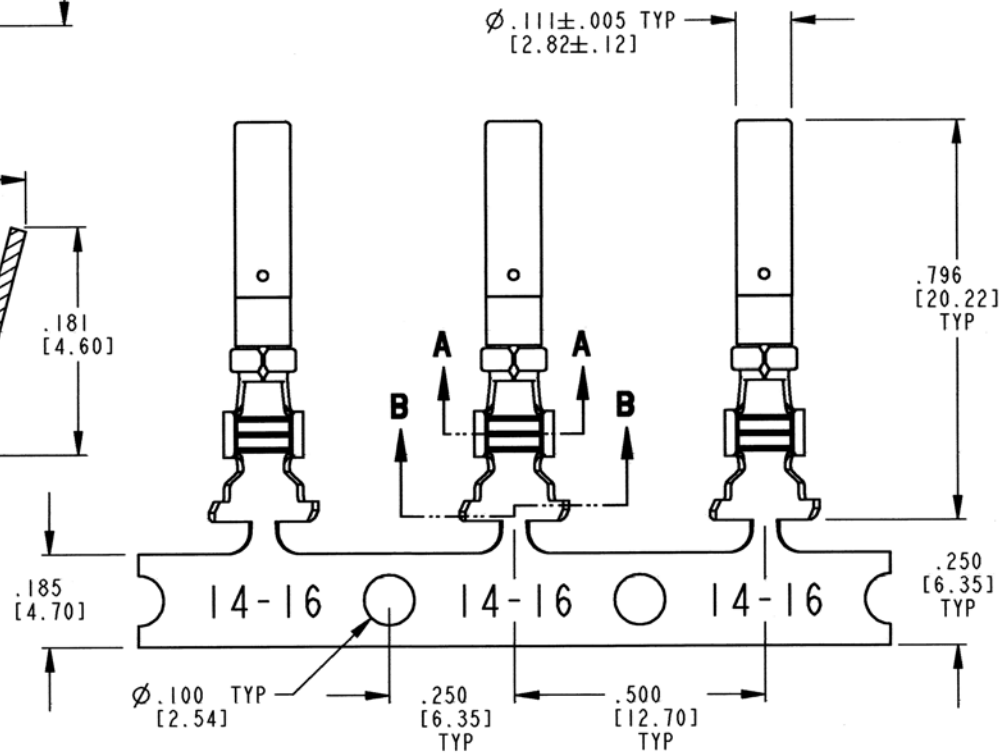

7. CONTACT BODY MATERIAL: COPPER ALLOY;
CONTACT SLEEVE MATERIAL: STAINLESS STEEL.
6. WHEN ** = 22 PLATING IS NICKEL.
** = 44 PLATING IS GOLD.
** = 77 PLATING IS TIN.
5. SEE 0425-015-0000 FOR CONTACT PERFORMANCE AND
WIRE APPLICATION CHARACTERISTICS.
4. THIS CONTACT MAY BE CRIMPED WITH DCT16-02-00 AUTOMATIC
DIE OR DTT-16-00 HAND TOOL. SEE DRAWING 0425-203-0000
FOR APPLICABLE WIRE SIZE, INSULATION DIAMETER RANGE,
AND CRIMPING INFORMATION.
3. ONE REEL CONTAINS APPROXIMATELY 4000 CONTACTS.
2. DIMENSIONAL TOLERANCE: $\pm .025$ [0.63].
1. DIMENSIONS ARE IN INCHES [mm].

NOTES: UNLESS OTHERWISE SPECIFIED

SIGNATURE & DATE	
DR	J. APOSTOL 03DEC2009
CHK	D. M... 6/25/10
PE	D. M... 6/25/10
APPD	R. Reed 6-25-10
SCALE	NONE
WT	

**STAMPED CONTACT
SOCKET
SIZE 16**

ENVELOPE

EP	MATL. CODE
3850 INDUSTRIAL AVE. HEMET, CA 92545	
B	1062-14-01**
DWG SIZE	CODE 11139 SHEET OF